

1 inch equals 50 feet



Locator Map Not to Scale

City of Mandan
Morton County, ND

Figure 1
90% DESIGN
MAY 2024

MANDAN PARKS & REC

Date: 5/8/2024



Information depicted may include data unverified by AE2S. Any reliance upon such data is at the user's own risk. AE2S does not warrant this map or its features are either spatially or temporally accurate.

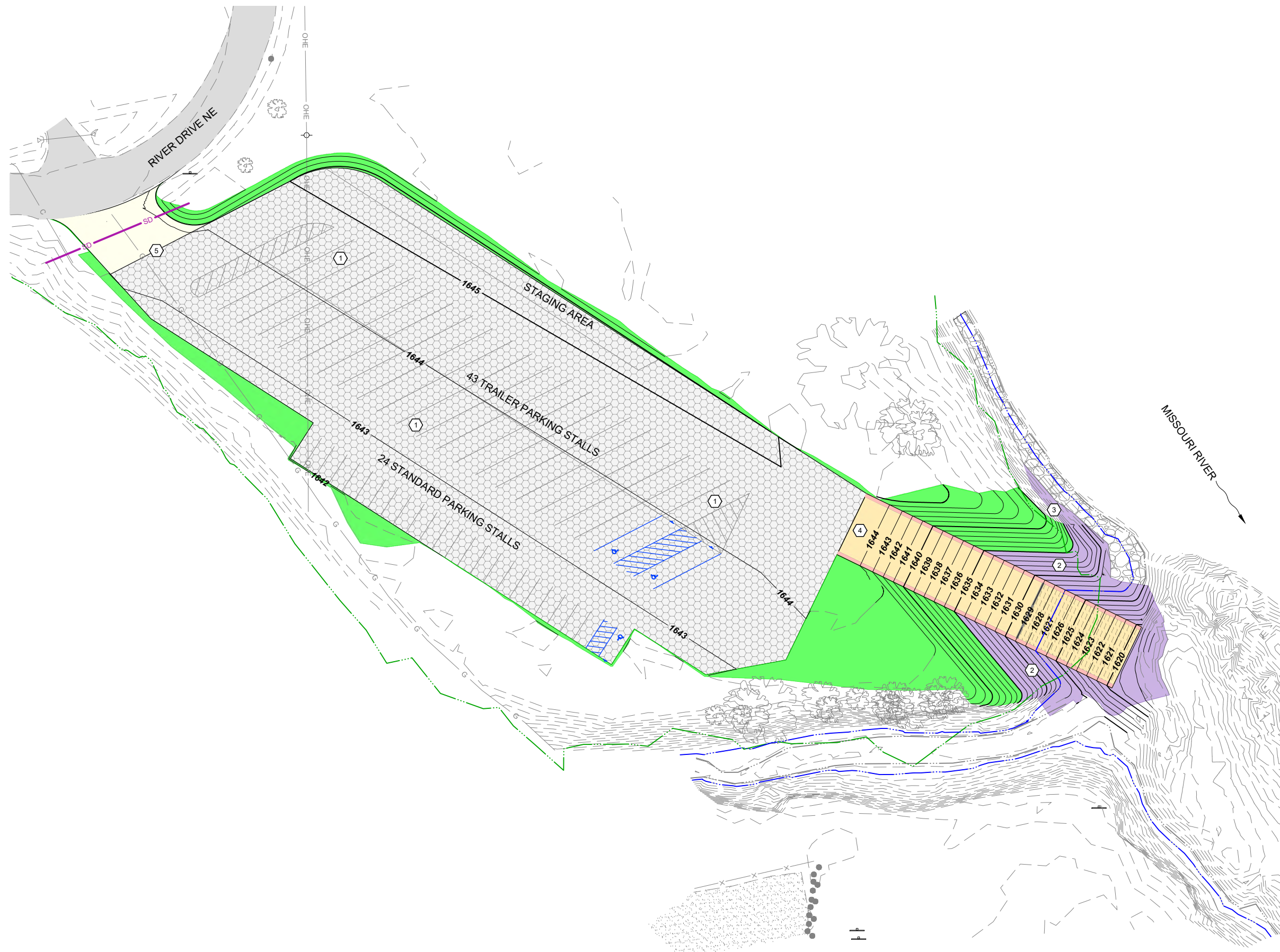

Certification of Individual Project Design Disciplines Are Included On Their Individual Drawings, Respectively

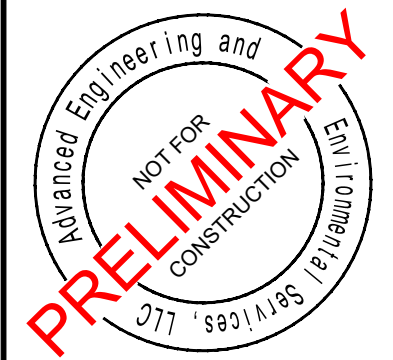

LEGEND

	RIP RAP NDDOT GRADE 1 (ANGULAR)
	RIP RAP 9 INCH D50
	SEEDING
	PAVER
	BITUMINOUS
	CAST IN PLACE CONCRETE
	CONCRETE PUSH SECTION
	DELINEATED WETLAND
	APPROXIMATE NORMAL WATER ELEVATION
	SURVEYED WATER ELEVATION OCTOBER 19, 2023

- CONSTRUCTION NOTES**
- PARKING LOT SURFACE TO UTILIZE TRUEGRID PROPLUS PERMEABLE PAVERS. SEE DETAIL XX.
 - RIP RAP ON 3:1 SLOPES TOWARD BOAT RAMP SHALL BE PLACED SECURELY TO MINIMIZE RISK OF ROCK MOVEMENT. SEE DETAIL XX.
 - ROCK PLACED AGAINST EXISTING RIP RAP SHALL BE PLACED CAUTIOUSLY TO AVOID DISTURBANCE OF EXISTING ROCK. SEE DETAIL XX.
 - CONTRACTOR SHALL ENSURE SMOOTH TRANSITION FROM CONCRETE RAMP TO TOP OF PERMEABLE PAVERS.
 - CONTRACTOR SHALL ENSURE SMOOTH TRANSITION FROM NEW BITUMINOUS TO TOP OF PERMEABLE PAVERS.

COORDINATE SYSTEM:
NORTH DAKOTA STATE PLANE - SOUTH ZONE - INTERNATIONAL FOOT (NAD83)

VERTICAL DATUM:
NORTH AMERICAN VERTICAL DATUM OF 1988 (NAVD 88)

SITE IMPROVEMENTS OVERVIEW

CLIENT:	CITY OF MANDAN MANDAN NORTH DAKOTA	PREPARED BY: RFM
		CHECKED BY: JGK
		APPROVED BY: JGK

PROJECT NO: P10200-2023-001	SHEET DESIGNATOR:	SHEET NO:
DATE: MAY 2024		C104
ALT. PROJECT NO:		

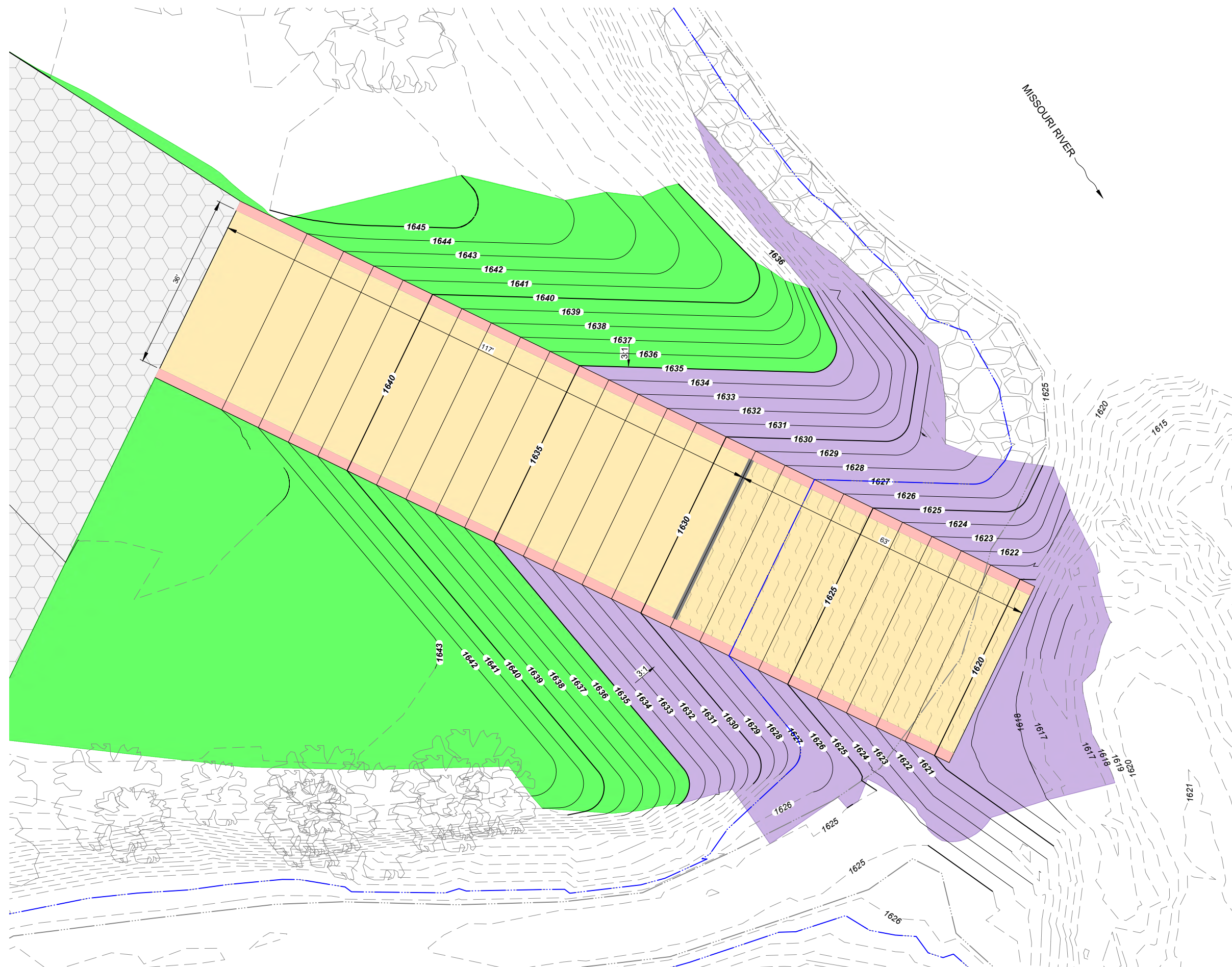

Certification of Individual Project Design Disciplines Are Included On Their Individual Drawings, Respectively



STATUS: **PRELIMINARY - NOT FOR CONSTRUCTION**

SYMBOL	DATE	APPROVED

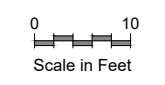

LEGEND

- RIP RAP NDDOT GRADE 1
- RIP RAP 9 INCH D50
- SEEDING AND ECB
- PAVER
- BITUMINOUS
- CAST IN PLACE CONCRETE
- CONCRETE PUSH SECTION

COORDINATE SYSTEM:
NORTH DAKOTA STATE PLANE - SOUTH ZONE - INTERNATIONAL FOOT (NAD83)

VERTICAL DATUM:
NORTH AMERICAN VERTICAL DATUM OF 1988 (NAVD 88)

SHEET TITLE: **BOAT RAMP RESTORATION**

CLIENT: **CITY OF MANDAN**
MANDAN NORTH DAKOTA

PREPARED BY: RFM
CHECKED BY: JGK
APPROVED BY: JGK

PROJECT NO: P10200-2023-001 SHEET DESIGNATOR: SHEET NO: **C108**

DATE: MAY 2024
ALT. PROJECT NO:

MANDAN BOAT RAMP

Advanced Engineering and Environmental Services, LLC www.ae2s.com

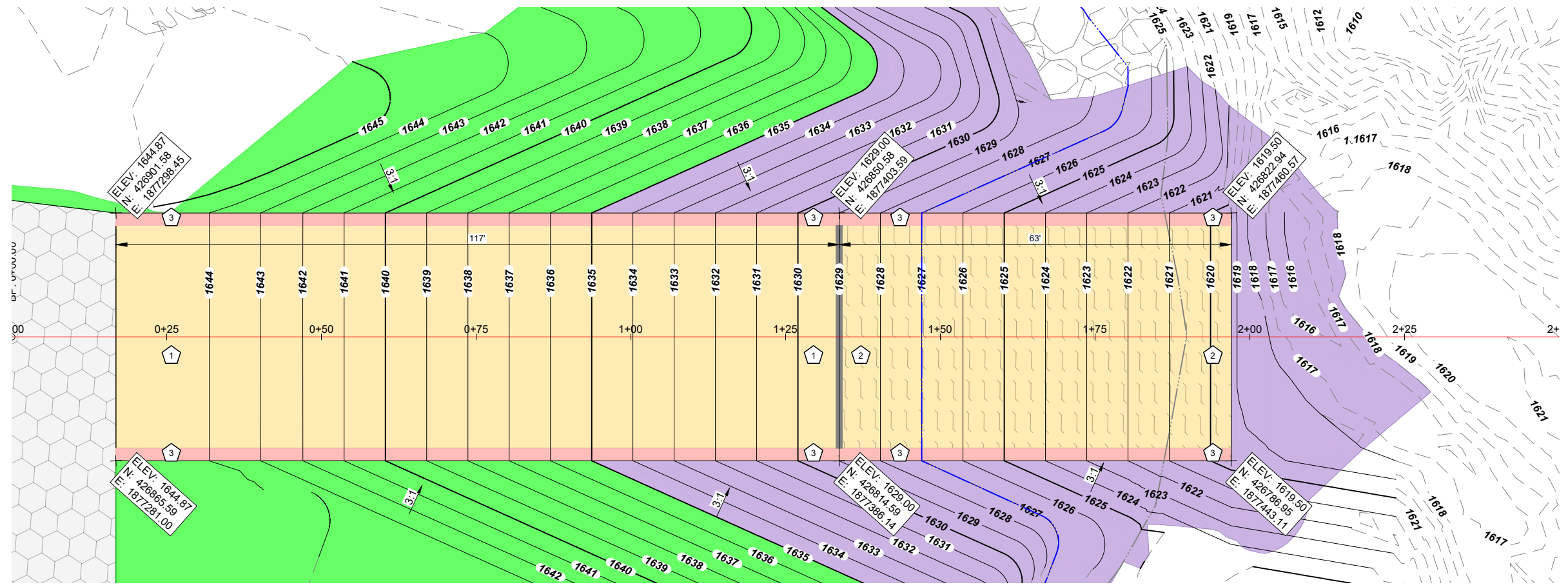

AES
2

Certification of Individual Project Design Disciplines Are Included On Their Individual Drawings, Respectively

Advanced Engineering and Environmental Services, LLC
NOT FOR CONSTRUCTION
PRELIMINARY

STATUS: **PRELIMINARY - NOT FOR CONSTRUCTION**

SYMBOL: DATE: APPR:



- CONSTRUCTION NOTES**
- 1 CONCRETE SLAB TO BE CAST IN-PLACE.
 - 2 CONCRETE PUSH SECTION.
 - 3 2' WIDE X 2' DEEP TRENCH WITH 9 INCH D50 RIP RAP
 - 4 RIP RAP SHALL BE PLACED AT THE END OF THE BOAT RAMP SUCH THAT IT IS GENERALLY LEVEL WITH THE TOP OF CONCRETE OR UP TO 6 INCHES ABOVE TOP OF CONCRETE.

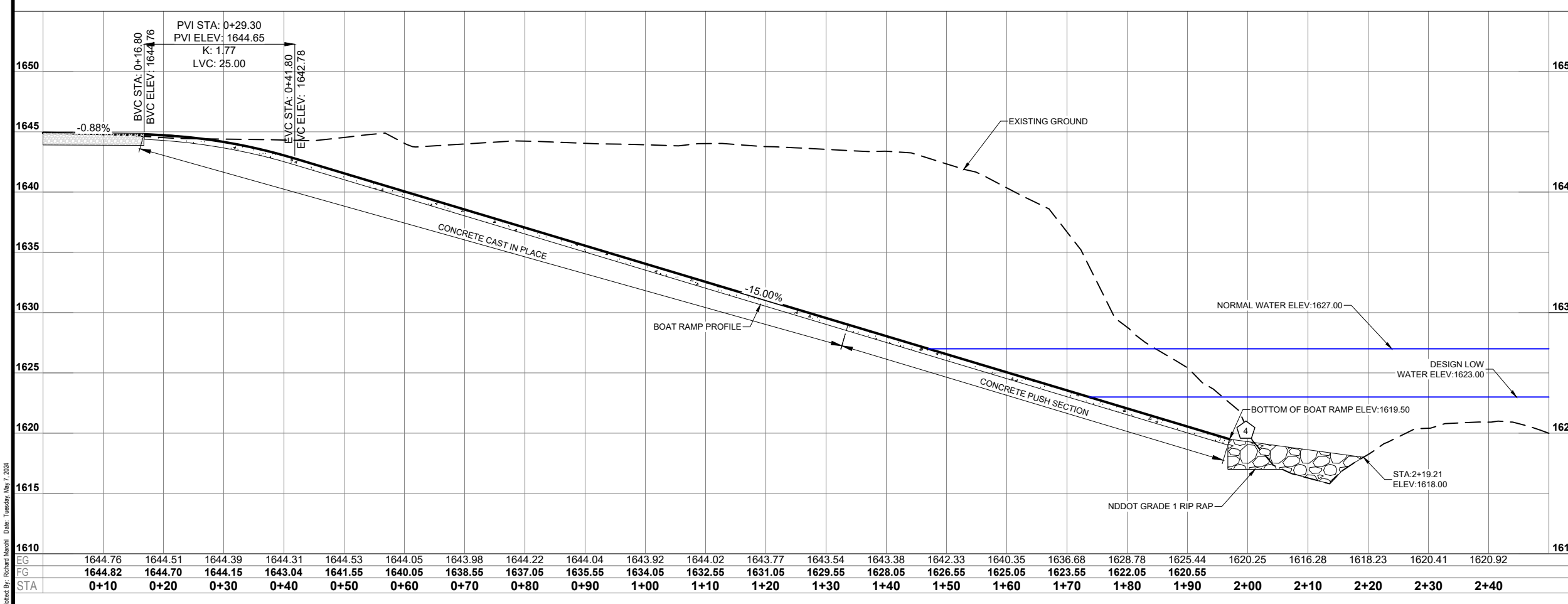

COORDINATE SYSTEM:
NORTH DAKOTA STATE PLANE - SOUTH ZONE - INTERNATIONAL FOOT (NAD83)

VERTICAL DATUM:
NORTH AMERICAN VERTICAL DATUM OF 1988 (NAVD 88)

SHEET TITLE: **BOAT RAMP PROFILE**

CLIENT: **CITY OF MANDAN**
MANDAN NORTH DAKOTA

PREPARED BY: RFM
CHECKED BY: JGK
APPROVED BY: JGK

PROJECT NO: P10200-2023-001 SHEET DESIGNATOR: SHEET NO: **C201**

DATE: MAY 2024
ALT. PROJECT NO: